

Applications in the range of protection class II and extra-low voltage for industry and LED technology

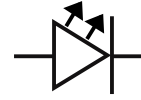

Application example



You therefore have the security of a clear separation of different applications without having to redo any incorrect connections. The color of the connectors indicates the links that belong together.

General

The two-pole connectors are based on the 3 pole variant, but with one pole not configured.

There are essentially two variants. One coding is specifically reserved for protection class II applications and is downwardly compatible with the 3 pole system with ground conductor (RST20i3).

This makes it possible to transition from a system with earthing contact to a 2 pole system – but not the other way round!

The other version is aimed at applications in the extra-low voltage range, such as serial or parallel LED wiring, or at industrial applications with 24V auxiliary power and AS-i. All connectors are mechanically coded. This means that only associated pairs of male and female can be connected with the correct polarity.

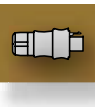

Coding

For daily updates visit the website at http://eshop.wieland-electric.com . Assembly instructions and other technical information can be found in the Technical Data or in e-KAT.					Application		250 V		Extra-low voltage	
					Mechanical coding, for example	Protection class II	LED serial, e.g. 24 V	LED parallel, AS-i	gray	black
Connector	1 x cable entry	Screw Spring clamp	yes	1 2		✓	✓	✓	✓	
	2 x cable entry	Screw Spring clamp	yes	1 2	✓	✓	✓	✓		
Distribution units	Distribution block 1I/3 O				✓	✓	✓	✓		
	RST compact distribution unit/multi-distribution unit				on request	on request	on request	on request		
	Individual distribution box				on request	on request	on request	on request		
	Series distribution unit for power LEDs						✓			
Device connectors	M16 device connector, modular, straight				✓	✓	✓	✓		
	M16 device connector, modular, angled 7°				✓	✓	✓	✓		
	M25 device connector, standard				✓	✓	✓	✓		
	M20 device connector, standard				✓	✓	✓	✓		
	M20 device connector, modular, angled				✓	✓	✓	✓		
	M25 device connector, modular, angled				✓	✓	✓	✓		
Cable assemblies	Connection cable Male – Free end	pre-assembled	pre-assembled	pre-assembled	✓	✓	✓	✓		
	Connection cable Female – Free end	pre-assembled	pre-assembled	pre-assembled	✓	✓	✓	✓		
	Extension cable Male – Female	pre-assembled	pre-assembled	pre-assembled	✓	✓	✓	✓		
	Connection cable Europ. conn. SK II – Female	pre-assembled	pre-assembled	pre-assembled	✓	✓	✓	✓		
	Round cable	pre-assembled	pre-assembled	pre-assembled	✓	✓	✓	✓		
	AS-i profile cable	pre-assembled	pre-assembled	pre-assembled				✓		

Connectors

Female connector

Unmounted with cable gland.

See the Technical Data for insulation strip lengths as well as the ferrules to be used.

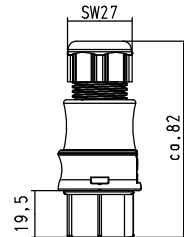

Application	Coding	Cable diameter in mm	Color	Part No.	Part No.
				with spring clamp connection	
				Wire	mm ² Ferrules
				rigid	0.5 – 2.5
				fine-stranded	0.5 – 1.5 with ferrules
				stranded	0.75 – 1.5 with ferrules
				with screw connection¹⁾	
				Wire	mm ²
				rigid	
				fine-stranded	0.75 – 6.0 ²⁾ without ferrules
				stranded	without ferrules
Protection class II 250 V	L, N	6 – 10	gray	96.021.0053.0	96.021.4053.0
			black	96.021.0053.1	96.021.4053.1
		10 – 14	gray	96.021.0153.0	96.021.4153.0
			black	96.021.0153.1	96.021.4153.1
		Illumination cable 13.3 x 5.3	gray	96.021.0453.0	96.021.4453.0
		H05RNH2-F2 x 1,5 ²	black	96.021.0453.1	96.021.4453.1
Extra-low volt. e.g. LED serial, 24V	1, 2	6 – 10	brown	96.021.0051.4	96.021.4051.4
		AS-i profile cable	brown	96.021.0951.4	96.021.4951.4
Extra-low volt. e.g. LED parallel, AS-i	+, -	Round cable 6 – 10	pebble gray	96.021.0050.8	96.021.4050.8
		AS-i profile cable	pebble gray	96.021.0950.8	96.021.4950.8

Male connector

Unmounted with cable gland and locking device.

See the Technical Data for insulation strip lengths as well as the ferrules to be used.

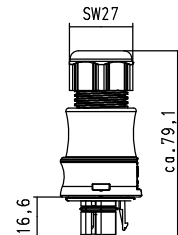

Application	Coding	Cable diameter in mm	Color	Part No.	Part No.
				with spring clamp connection	
				Wire	mm ² Ferrules
				rigid	0.5 – 2.5
				fine-stranded	0.5 – 1.5 with ferrules
				stranded	0.75 – 1.5 with ferrules
				with screw connection¹⁾	
				Wire	mm ²
				rigid	
				fine-stranded	0.75 – 6.0 ²⁾ without ferrules
				stranded	without ferrules
Protection class II 250 V	N, L	6 – 10	gray	96.022.0053.0	96.022.4053.0
			black	96.022.0053.1	96.022.4053.1
		10 – 14	gray	96.022.0153.0	96.022.4153.0
			black	96.022.0153.1	96.022.4153.1
		Illumination cable 13.3 x 5.3	gray	96.022.0453.0	96.022.4453.0
		H05RNH2-F2 x 1,5 ²	black	96.022.0453.1	96.022.4453.1
Extra-low volt. e.g. LED serial, 24V	2, 1	6 – 10	brown	96.022.0051.4	96.022.4051.4
		AS-i profile cable	brown	96.022.0951.4	96.022.4951.4
Extra-low volt. e.g. LED parallel, AS-i	-, +	Round cable 6 – 10	pebble gray	96.022.0050.8	96.022.4050.8
		AS-i profile cable	pebble gray	96.022.0950.8	96.022.4950.8

¹⁾ With wire protection available on request

²⁾ With 6,0 mm² wires, the pull and bending forces at the connector must be taken into consideration and compensated using suitable measures if required. See also chapter on Technical Data and e-KAT.

Connector, angled

Female connector

Unmounted with cable gland.
90° angle.

See the Technical Data for insulation strip lengths as well as the ferrules to be used.

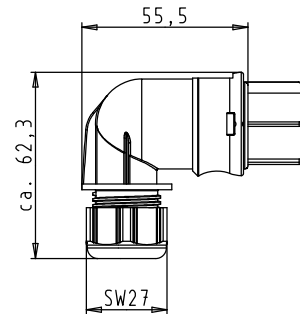
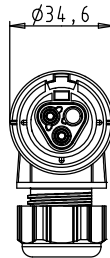

Application	Coding	Cable diameter in mm	Color	Part No.	Part No.
				with spring clamp connection	with screw connection¹⁾
				Wire	Wire
				rigid	rigid
				mm ²	mm ²
				0,5 – 2,5	0,75 – 6,0 ²⁾
				fine-stranded	without ferrules
				0,5 – 1,5	without ferrules
				with ferrules	
				stranded	
				0,75 – 1,5	
				with ferrules	
Protection class II 250 V	L, N	6 – 10	gray	96.023.0053.0	96.023.4053.0
			black	96.023.0053.1	96.023.4053.1
		10 – 14	gray	96.023.0153.0	96.023.4153.0
			black	96.023.0153.1	96.023.4153.1
		Illumination cable 13.3 x 5.3	gray	96.023.0453.0	96.023.4453.0
		H05RNH2-F2 x 1,5 ²⁾	black	96.023.0453.1	96.023.4453.1
Extra-low volt. e.g. LED serial, 24V	1, 2	6 – 10	brown	96.023.0051.4	96.023.4051.4
		AS-i profile cable	brown	96.023.0951.4	96.023.4951.4
Extra-low volt. e.g. LED parallel, AS-i	+, -	Round cable 6 – 10	pebble gray	96.023.0050.8	96.023.4050.8
		AS-i profile cable	pebble gray	96.023.0950.8	96.023.4950.8

Male connector

Unmounted with cable gland.
90° angle.

See the Technical Data for insulation strip lengths as well as the ferrules to be used.

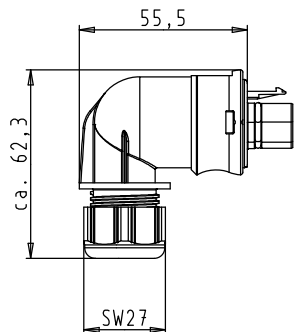
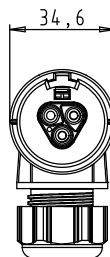

Application	Coding	Cable diameter in mm	Color	Part No.	Part No.
				with spring clamp connection	with screw connection¹⁾
				Wire	Wire
				rigid	rigid
				mm ²	mm ²
				0,5 – 2,5	0,75 – 6,0 ²⁾
				fine-stranded	without ferrules
				0,5 – 1,5	without ferrules
				with ferrules	
				stranded	
				0,75 – 1,5	
				with ferrules	
Protection class II 250 V	N, L	6 – 10	gray	96.024.0053.0	96.024.4053.0
			black	96.024.0053.1	96.024.4053.1
		10 – 14	gray	96.024.0153.0	96.024.4153.0
			black	96.024.0153.1	96.024.4153.1
		Illumination cable 13.3 x 5.3	gray	96.024.0453.0	96.024.4453.0
		H05RNH2-F2 x 1,5 ²⁾	black	96.024.0453.1	96.024.4453.1
Extra-low volt. e.g. LED serial, 24V	2, 1	6 – 10	brown	96.024.0051.4	96.024.4051.4
		AS-i profile cable	brown	96.024.0951.4	96.024.4951.4
Extra-low volt. e.g. LED parallel, AS-i	-, +	Round cable 6 – 10	pebble gray	96.024.0050.8	96.024.4050.8
		AS-i profile cable	pebble gray	96.024.0950.8	96.024.4950.8

¹⁾ With wire protection available on request

²⁾ With 6,0 mm² wires, the pull and bending forces at the connector must be taken into consideration and compensated using suitable measures if required. See also chapter on Technical Data and e-KAT.

Splitter connector

Female connector

Unmounted with cable gland.

See the Technical Data for insulation strip lengths as well as the ferrules to be used.

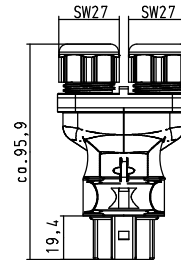
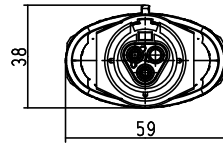

Application	Coding	Cable diameter in mm	Color	Part No.	Part No.
				with spring clamp connection	with screw connection¹⁾
				Wire	Wire
				mm ²	mm ²
				rigid	rigid
				0.5 – 2.5	
				fine-stranded	0.75 – 2.5
				0.5 – 1.5	without ferrules
				with ferrules	
				stranded	without ferrules
				0.75 – 1.5	
				with ferrules	
Protection class II 250 V	L, N	6 – 10	gray	96.021.0253.0	96.021.4253.0
			black	96.021.0253.1	96.021.4253.1
		10 – 14	gray	96.021.0353.0	96.021.4353.0
			black	96.021.0353.1	96.021.4353.1
		illumination cable 13.3 x 5.3	gray	on request	on request
		H05RNH2-F2 x 1,5 ²	black	on request	on request
Extra-low volt. e.g. LED serial, 24 VV	1, 2	6 – 10	brown	96.021.0251.4	96.021.4251.4
		10 – 14	brown	96.021.0351.4	96.021.4351.4

Mounting plate For splitter connectors

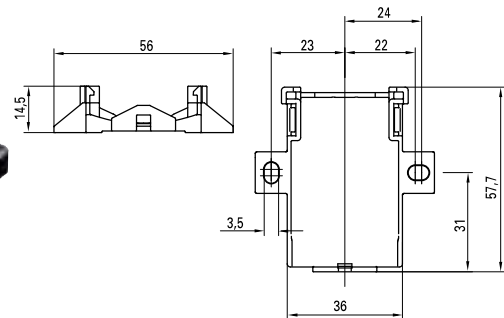

Color	Part No.
gray	01.006.1553.0
black	01.006.1553.1

¹⁾ With wire protection available on request

M 25 device connector, standard

Female connector

Correct positioning guaranteed due to flattened thread. Fastening with screws from outside.

See the Technical Data for insulation strip lengths as well as the ferrules to be used.

For spacer rings for unlocking at the device connector, see Accessories.

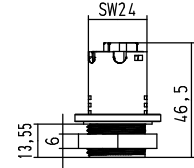
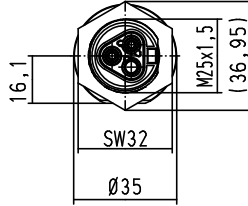

Application Coding Color

Part No.

Part No.

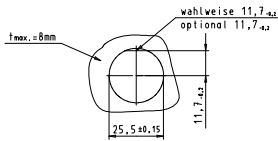

with spring clamp connection

Wire	mm ²	Ferrules
rigid	0,5 – 2,5	
fine-stranded	0,5 – 1,5	with ferrules
stranded	0,75 – 1,5	with ferrules
Term. poles	2	
Thread	M25 x 1,5	
Gland	outside	

with screw connection¹⁾

Wire	mm ²	Ferrules
rigid		
fine-stranded	0,75 – 6,0	without ferrules
stranded		without ferrules
Term. poles	1	
Thread	M25 x 1,5	
Gland	outside	

250V	Protection class II		L, N	gray black
Extra-low voltage	e.g. LED serial, 24 V		1, 2	brown
			+, -	pebble gray

96.021.1053.0	96.021.1053.1	96.021.1051.4
96.021.1050.8		

96.021.5053.0	96.021.5053.1	96.021.5051.4
96.021.5050.8		

Male connector

Correct positioning guaranteed due to flattened thread. Fastening with screws from outside. With locking device.

See the Technical Data for insulation strip lengths as well as the ferrules to be used.

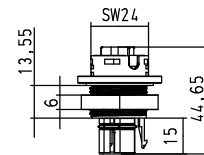
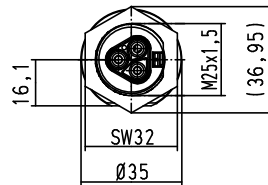

Application Coding Color

Part No.

Part No.

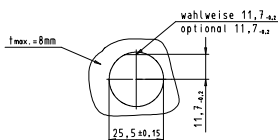

with spring clamp connection

Wire	mm ²	Ferrules
rigid	0,5 – 2,5	
fine-stranded	0,5 – 1,5	with ferrules
stranded	0,75 – 1,5	with ferrules
Term. poles	2	
Thread	M25 x 1,5	
Gland	outside	

with screw connection¹⁾

Wire	mm ²	Ferrules
rigid		
fine-stranded	0,75 – 6,0 ²⁾	without ferrules
stranded		without ferrules
Term. poles	1	
Thread	M25 x 1,5	
Gland	outside	

250V	Protection class II		N, L	gray black
Extra-low voltage	e.g. LED serial, 24 V		1, 2	brown
			-, +	pebble gray

96.022.1053.0	96.022.1053.1	96.022.1051.4
96.022.1050.8		

96.022.5053.0	96.022.5053.1	96.022.5051.4
96.022.5050.8		

¹⁾ With wire protection available on request

M 16 device connector, modular, straight

Female connector

Correct positioning guaranteed due to flattened thread. Fastening with screws from inside.

See the Technical Data for insulation strip lengths as well as the ferrules to be used.

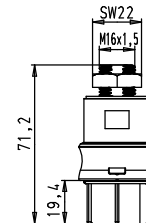

Application Coding Color

Part No.

Part No.

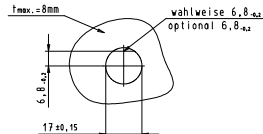

with spring clamp connection

Wire	mm ²	Ferrules
rigid	0.5 – 2.5	
fine-stranded	0.5 – 1.5	with ferrules
stranded	0.75 – 1.5	with ferrules
Term. poles	2	
Thread	M16 x 1.5	
Gland	inside	

with screw connection¹⁾

Wire	mm ²	Ferrules
rigid		
fine-stranded	0.75 – 6.0	without ferrules
stranded		without ferrules
Term. poles	1	
Thread	M16 x 1.5	
Gland	inside	

250V	Protection class II		L, N	gray black
Extra-low voltage	e.g. LED serial, 24 V		1, 2	brown
	e.g. LED parallel, AS-i		+, -	pebble gray

96.021.2153.0
96.021.2153.1
96.021.2151.4
96.021.2150.8

96.021.6153.0
96.021.6153.1
96.021.6151.4
96.021.6150.8

Male connector

Correct positioning guaranteed due to flattened thread. Fastening with screws from inside.
With locking device.

See the Technical Data for insulation strip lengths as well as the ferrules to be used.

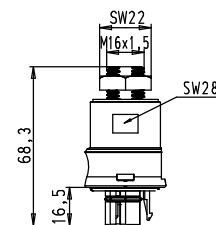

Application Coding Color

Part No.

Part No.

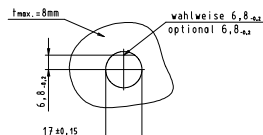

with spring clamp connection

Wire	mm ²	Ferrules
rigid	0.5 – 2.5	
fine-stranded	0.5 – 1.5	with ferrules
stranded	0.75 – 1.5	with ferrules
Term. poles	2	
Thread	M16 x 1.5	
Gland	inside	

with screw connection¹⁾

Wire	mm ²	Ferrules
rigid		
fine-stranded	0.75 – 6.0	without ferrules
stranded		without ferrules
Term. poles	1	
Thread	M16 x 1.5	
Gland	inside	

250V	Protection class II		N, L	gray black
Extra-low voltage	e.g. LED serial, 24 V		2, 1	brown
	e.g. LED parallel, AS-i		-, +	pebble gray

96.022.2153.0
96.022.2153.1
96.022.2151.4
96.022.2150.8

96.022.6153.0
96.022.6153.1
96.022.6151.4
96.022.6150.8

¹⁾ With wire protection available on request

M 16 device connector, modular, 7° angle

Female connector

Correct positioning guaranteed due to flattened thread. Fastening with screws from inside. With locking device.

See the Technical Data for insulation strip lengths as well as the ferrules to be used.

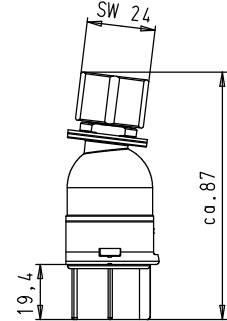

Application Coding Color

Part No.

Part No.

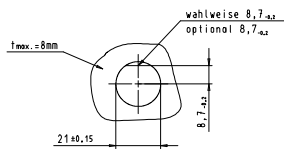

with spring clamp connection

Wire	mm ²	Ferrules
rigid	0.5 – 2.5	
fine-stranded	0.5 – 1.5	with ferrules
stranded	0.75 – 1.5	with ferrules
Term. poles	2	
Thread	M16 x 1.5	
Gland	inside	

with screw connection¹⁾

Wire	mm ²	Ferrules
rigid		
fine-stranded	0.75 – 6.0	without ferrules
stranded		without ferrules
Term. poles	1	
Thread	M16 x 1.5	
Gland	inside	

250V	Protection class II		L, N	gray black
Extra-low voltage	e.g. LED serial, 24 V		1, 2	brown
	e.g. LED parallel, AS-i		+, -	pebble gray

96.025.2153.0
96.025.2153.1
96.025.2151.4

96.025.6153.0
96.025.6153.1
96.025.6151.4

96.025.6150.8

Male connector

Correct positioning guaranteed due to flattened thread. Fastening with screws from inside. With locking device.

See the Technical Data for insulation strip lengths as well as the ferrules to be used.

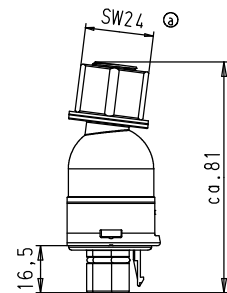

Application Coding Color

Part No.

Part No.

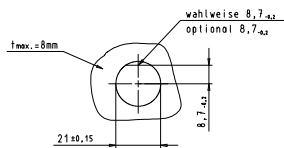

with spring clamp connection

Wire	mm ²	Ferrules
rigid	0.5 – 2.5	
fine-stranded	0.5 – 1.5	with ferrules
stranded	0.75 – 1.5	with ferrules
Term. poles	2	
Thread	M16 x 1.5	
Gland	inside	

with screw connection¹⁾

Wire	mm ²	Ferrules
rigid		
fine-stranded	0.75 – 6.0	without ferrules
stranded		without ferrules
Term. poles	1	
Thread	M16 x 1.5	
Gland	inside	

250V	Protection class II		N, L	gray black
Extra-low voltage	e.g. LED serial, 24 V		2, 1	brown
	e.g. LED parallel, AS-i		-, +	pebble gray

96.026.2153.0
96.026.2153.1
96.026.2151.4

96.026.6153.0
96.026.6153.1
96.026.6151.4

96.026.6150.8

¹⁾ With wire protection available on request

M 20 device connector, standard

Female connector

Correct positioning guaranteed due to flattened thread. Fastening with screws from inside.

See the Technical Data for insulation strip lengths as well as the ferrules to be used.

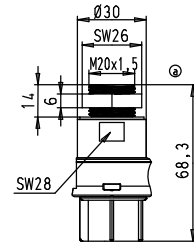
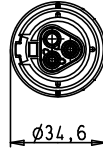

Application	Coding	Color	Part No.	Part No.
			with spring clamp connection	with screw connection¹⁾
			Wire	Wire
			rigid	rigid
			mm ²	mm ²
			0.5 – 2.5	0.75 – 6.0
			fine-stranded	without ferrules
			0.5 – 1.5	without ferrules
			stranded	without ferrules
			0.75 – 1.5	
			Term. poles	1
			2	
			Thread	M20 x 1.5
			M20 x 1.5	
			Gland	inside
			inside	
250V	Protection class II	L, N	gray	96.021.2053.0
Extra-low voltage	e.g. LED serial, 24 V	1, 2	black	96.021.2053.1
		1, 2	brown	96.021.6053.1
		+, -	pebble gray	96.021.6051.4
				96.021.6050.8

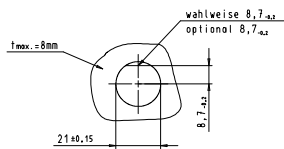

Application	Coding	Color
250V	Protection class II	L, N
Extra-low voltage	e.g. LED serial, 24 V	1, 2
		1, 2
		+, -

Male connector

Correct positioning guaranteed due to flattened thread. Fastening with screws from inside. With locking device.

See the Technical Data for insulation strip lengths as well as the ferrules to be used.

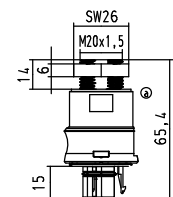

Application	Coding	Color	Part No.	Part No.
			with spring clamp connection	with screw connection¹⁾
			Wire	Wire
			rigid	rigid
			mm ²	mm ²
			0.5 – 2.5	0.75 – 6.0
			fine-stranded	without ferrules
			0.5 – 1.5	without ferrules
			stranded	without ferrules
			0.75 – 1.5	
			Term. poles	1
			2	
			Thread	M20 x 1.5
			M20 x 1.5	
			Gland	inside
			inside	
250V	Protection class II	N, L	gray	96.022.2053.0
Extra-low voltage	e.g. LED serial, 24 V	2, 1	black	96.022.2053.1
		2, 1	brown	96.022.6053.1
		-, +	pebble gray	96.022.6051.4
				96.022.6050.8

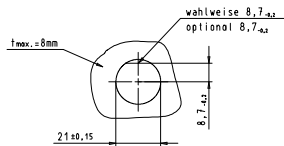

Application	Coding	Color
250V	Protection class II	N, L
Extra-low voltage	e.g. LED serial, 24 V	2, 1
		2, 1
		-, +

¹⁾ With wire protection available on request

M 20 device connector, modular, angled

Female connector

Correct positioning guaranteed due to flattened thread. Fastening with screws from inside.

See the Technical Data for insulation strip lengths as well as the ferrules to be used.

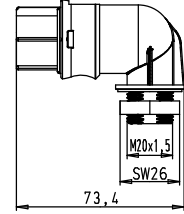

Application	Coding	Color	Part No.	Part No.
			with spring clamp connection	with screw connection¹⁾
			Wire	Wire
			rigid	rigid
			mm ²	mm ²
			0.5 – 2.5	0.75 – 6.0
			fine-stranded	0.75 – 6.0
			0.5 – 1.5	without ferrules
			stranded	without ferrules
			0.75 – 1.5	without ferrules
			Term. poles	1
			2	
			Thread	M20 x 1.5
			M20 x 1.5	
			Gland	inside
			inside	
250V	Protection class II	L, N	gray	96.023.2053.0
Extra-low voltage	e.g. LED serial, 24 V	1, 2	black	96.023.2053.1
		1, 2	brown	96.023.2051.4
		+, -	pebble gray	96.023.2050.8
250V	Protection class II	N, L	gray	96.024.2053.0
Extra-low voltage	e.g. LED serial, 24 V	2, 1	black	96.024.2053.1
		2, 1	brown	96.024.2051.4
		-, +	pebble gray	96.024.2050.8

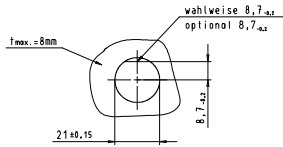

250V	Protection class II	L, N	gray
Extra-low voltage	e.g. LED serial, 24 V	1, 2	black
		1, 2	brown
		+, -	pebble gray

Male connector

Correct positioning guaranteed due to flattened thread. Fastening with screws from inside. With locking device.

See the Technical Data for insulation strip lengths as well as the ferrules to be used.

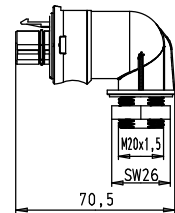
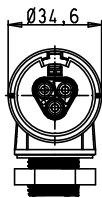

Application	Coding	Color	Part No.	Part No.
			with spring clamp connection	with screw connection¹⁾
			Wire	Wire
			rigid	rigid
			mm ²	mm ²
			0.5 – 2.5	0.75 – 6.0
			fine-stranded	0.75 – 6.0
			0.5 – 1.5	without ferrules
			stranded	without ferrules
			0.75 – 1.5	without ferrules
			Term. poles	1
			2	
			Thread	M20 x 1.5
			M20 x 1.5	
			Gland	inside
			inside	
250V	Protection class II	N, L	gray	96.024.2053.0
Extra-low voltage	e.g. LED serial, 24 V	2, 1	black	96.024.2053.1
		2, 1	brown	96.024.2051.4
		-, +	pebble gray	96.024.2050.8
250V	Protection class II	N, L	gray	96.024.6053.0
Extra-low voltage	e.g. LED serial, 24 V	2, 1	black	96.024.6053.1
		2, 1	brown	96.024.6051.4
		-, +	pebble gray	96.024.6050.8

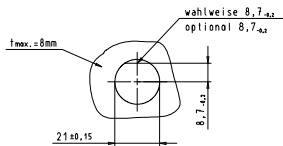

250V	Protection class II	N, L	gray
Extra-low voltage	e.g. LED serial, 24 V	2, 1	black
		2, 1	brown
		-, +	pebble gray

¹⁾ With wire protection available on request

M 25 device connector, modular, angled

Female connector

Correct positioning guaranteed due to flattened thread. Fastening with screws from inside.

See the Technical Data for insulation strip lengths as well as the ferrules to be used.

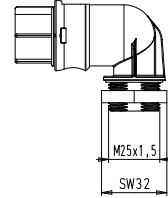
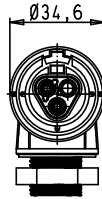

Application	Coding	Color	Part No.	Part No.
			with spring clamp connection	with screw connection¹⁾
			Wire	Wire
			rigid	rigid
			fine-stranded	fine-stranded
			stranded	stranded
			Term. poles	Term. poles
			Thread	Thread
			Gland	Gland
			96.023.2253.0	96.023.6253.0
			96.023.2253.1	96.023.6253.1
			96.023.2251.4	96.023.6251.4
			96.023.2250.8	96.023.6250.8

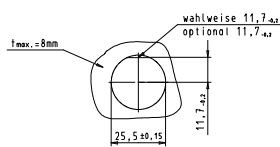

250V	Protection class II		L, N	gray
Extra-low voltage	e.g. LED serial, 24 V		1, 2	black
			+, -	pebble gray

Male connector

Correct positioning guaranteed due to flattened thread. Fastening with screws from inside. With locking device.

See the Technical Data for insulation strip lengths as well as the ferrules to be used.

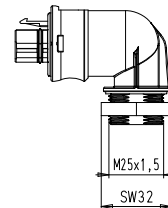
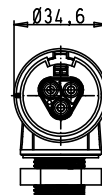

Application	Coding	Color	Part No.	Part No.
			with spring clamp connection	with screw connection¹⁾
			Wire	Wire
			rigid	rigid
			fine-stranded	fine-stranded
			stranded	stranded
			Term. poles	Term. poles
			Thread	Thread
			Gland	Gland
			96.024.2253.0	96.024.6253.0
			96.024.2253.1	96.024.6253.1
			96.024.2251.4	96.024.6251.4
			96.024.2250.8	96.024.6250.8

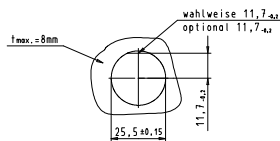

250V	Protection class II		N, L	gray
Extra-low voltage	e.g. LED serial, 24 V		2, 1	black
			-, +	pebble gray

¹⁾ With wire protection available on request

Accessories – Cover pieces

Female connector 2 to 3 pole

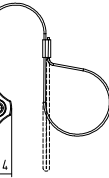
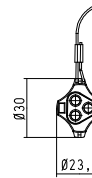
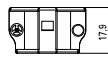

Color	Part No.	Part No.
	not captive against loss	captive against loss
	Pole 2 – 3 pole	Pole 2 – 3 pole
	Safe locking device unused male connectors	Safe locking device unused male connectors
gray	05.564.4453.0	99.415.6205.2
black	05.564.4453.1	99.416.6205.2

Male connector 2 to 3 pole

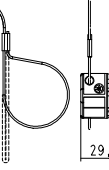
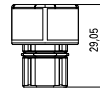

Color	Part No.	Part No.
	not captive against loss	captive against loss
	Pole 2 – 3 pole	Pole 2 – 3 pole
	Safe locking device unused female connectors	Safe locking device unused female connectors
gray	Z5.564.4553.0	99.413.6205.2
black	Z5.564.4553.1	99.414.6205.2

Cable assemblies 1.5 mm², 16A

H05VV-F 2x1.5 containing halogen  Protection class II: N = BU L = BN e.g. LED serial, 24 V: 1 = BU 2 = BN Observe the installation instructions in the Technical Data that follow the product pages. Cable ¹⁾ and shrinkage tube Color black																																												
	<table border="1"> <tr><td colspan="2">Female – Male</td></tr> <tr><td>Extension cable</td><td></td></tr> <tr><td>Locking device</td><td>yes</td></tr> </table>	Female – Male		Extension cable		Locking device	yes	<table border="1"> <tr><td colspan="2">Female – Free end</td></tr> <tr><td colspan="2">Connection cable</td></tr> <tr><td>Wire ends</td><td>ultrason. welded</td></tr> <tr><td>Sheath strip length</td><td>35 mm</td></tr> <tr><td>Insul. strip length</td><td>9 mm</td></tr> <tr><td>Locking device</td><td>possible</td></tr> </table>	Female – Free end		Connection cable		Wire ends	ultrason. welded	Sheath strip length	35 mm	Insul. strip length	9 mm	Locking device	possible	<table border="1"> <tr><td colspan="2">Male – Free end</td></tr> <tr><td colspan="2">Connection cable</td></tr> <tr><td>Wire ends</td><td>ultrason. welded</td></tr> <tr><td>Sheath strip length</td><td>35 mm</td></tr> <tr><td>Insul. strip length</td><td>9 mm</td></tr> <tr><td>Locking device</td><td>yes</td></tr> </table>	Male – Free end		Connection cable		Wire ends	ultrason. welded	Sheath strip length	35 mm	Insul. strip length	9 mm	Locking device	yes	<table border="1"> <tr><td colspan="2">European connector SKII</td></tr> <tr><td colspan="2">Power cable</td></tr> <tr><td>Female</td><td>RST</td></tr> <tr><td>Color</td><td>gray</td></tr> <tr><td>Cable color</td><td>gray</td></tr> </table>	European connector SKII		Power cable		Female	RST	Color	gray	Cable color	gray
Female – Male																																												
Extension cable																																												
Locking device	yes																																											
Female – Free end																																												
Connection cable																																												
Wire ends	ultrason. welded																																											
Sheath strip length	35 mm																																											
Insul. strip length	9 mm																																											
Locking device	possible																																											
Male – Free end																																												
Connection cable																																												
Wire ends	ultrason. welded																																											
Sheath strip length	35 mm																																											
Insul. strip length	9 mm																																											
Locking device	yes																																											
European connector SKII																																												
Power cable																																												
Female	RST																																											
Color	gray																																											
Cable color	gray																																											
Application	Length ²⁾ m	Part No.	Part No.	Part No.	Part No.																																							
Protection class II	1.0 2.0 3.0 4.0 5.0 6.0 7.0 8.0	96.222.1000.1 96.222.2000.1 96.222.3000.1 96.222.4000.1 96.222.5000.1 96.222.6000.1 96.222.7000.1 96.222.8000.1	96.222.1003.1 96.222.2003.1 96.222.3003.1 96.222.4003.1 96.222.5003.1 96.222.6003.1 96.222.7003.1 96.222.8003.1	96.222.1004.1 96.222.2004.1 96.222.3004.1 96.222.4004.1 96.222.5004.1 96.222.6004.1 96.222.7004.1 96.222.8004.1																																								
Protection class II 250 V	1.5 2.5				99.710.0000.7 99.711.0000.7																																							
Extra-low voltage e.g. LED serial, 24 V	1.0 2.0 3.0 4.0 5.0 6.0 7.0 8.0	96.222.1002.4 96.222.2002.4 96.222.3002.4 96.222.4002.4 96.222.5002.4 96.222.6002.4 96.222.7002.4 96.222.8002.4	96.222.1007.4 96.222.2007.4 96.222.3007.4 96.222.4007.4 96.222.5007.4 96.222.6007.4 96.222.7007.4 96.222.8007.4	96.222.1008.4 96.222.2008.4 96.222.3008.4 96.222.4008.4 96.222.5008.4 96.222.6008.4 96.222.7008.4 96.222.8008.4																																								
Extra-low voltage e.g. LED parallel, AS-I	1.0 2.0 3.0 4.0 5.0 6.0 7.0 8.0	on request	on request	on request																																								



¹⁾ Other cables available on request
²⁾ Other lengths available on request

Cable assemblies 1.5 mm², 16A

H07RN-F 2x1.5 Insulating rubber compound  Protection class II: N = BU L = BN e.g. LED serial, 24 V: 1 = BU 2 = BN Observe the installation instructions in the Technical Data that follow the product pages. Cable ¹⁾ and shrinkage tube Color black		 Female – Male Extension cable Locking device yes	 Female – Free end Connection cable Wire ends ultrason. welded Sheath strip length 35 mm Insul. strip length 9 mm Locking device possible	 Male – Free end Connection cable Wire ends ultrason. welded Sheath strip length 35 mm Insul. strip length 9 mm Locking device yes	 European connector SKII Power cable Buchse RST Color black Color Cable black
Application	Length ²⁾ m	Part No.	Part No.	Part No.	Part No.
Protection class II	1.0 2.0 3.0 4.0 5.0 6.0 7.0 8.0	96.222.1030.1 96.222.2030.1 96.222.3030.1 96.222.4030.1 96.222.5030.1 96.222.6030.1 96.222.7030.1 96.222.8030.1	96.222.1033.1 96.222.2033.1 96.222.3033.1 96.222.4033.1 96.222.5033.1 96.222.6033.1 96.222.7033.1 96.222.8033.1	96.222.1034.1 96.222.2034.1 96.222.3034.1 96.222.4034.1 96.222.5034.1 96.222.6034.1 96.222.7034.1 96.222.8034.1	
Protection class II	1.5 2.5				99.708.0000.7 99.709.0000.7
Extra-low voltage e.g. LED serial, 24 V	1.0 2.0 3.0 4.0 5.0 6.0 7.0 8.0	96.222.1032.4 96.222.2032.4 96.222.3032.4 96.222.4032.4 96.222.5032.4 96.222.6032.4 96.222.7032.4 96.222.8032.4	96.222.1037.4 96.222.2037.4 96.222.3037.4 96.222.4037.4 96.222.5037.4 96.222.6037.4 96.222.7037.4 96.222.8037.4	96.222.1038.4 96.222.2038.4 96.222.3038.4 96.222.4038.4 96.222.5038.4 96.222.6038.4 96.222.7038.4 96.222.8038.4	
Extra-low voltage e.g. LED parallel, AS-i	1.0 2.0 3.0 4.0 5.0 6.0 7.0 8.0	on request	on request	on request	

¹⁾ Other cables available on request
²⁾ Other lengths available on request

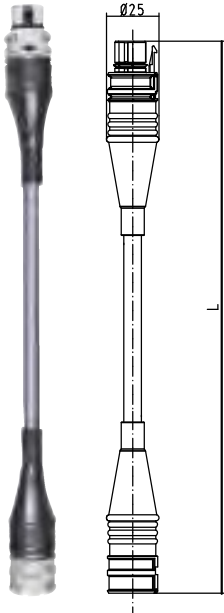
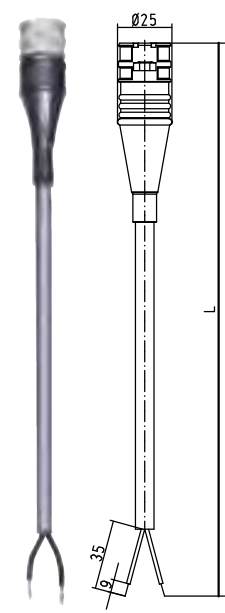
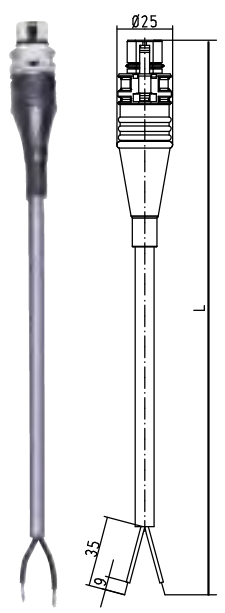
Cable assemblies 1.5 mm², 16 A, AS-i, 24V auxiliary voltage, LED

<p>Ölflex Classic 100 2x1.5</p> <p>containing halogen</p>  <p>e.g. LED parallel, ASI-i: + = BU - = BN</p> <p>e.g. LED serial, 24 V: 1 = BU 2 = BN</p> <p>Observe the installation instructions in the Technical Data that follow the product pages.</p>  <p>Cable¹⁾ color gray</p>	 <p>Female – Male</p> <table border="1"> <tr><td>Extension cable</td><td></td></tr> <tr><td>Locking device</td><td>yes</td></tr> </table>	Extension cable		Locking device	yes	 <p>Female – Free end</p> <table border="1"> <tr><td>Connection cable</td><td></td></tr> <tr><td>Wire ends</td><td>ultrason. welded</td></tr> <tr><td>Sheath strip length</td><td>35 mm</td></tr> <tr><td>Insul. strip length</td><td>9 mm</td></tr> <tr><td>Locking device</td><td>possible</td></tr> </table>	Connection cable		Wire ends	ultrason. welded	Sheath strip length	35 mm	Insul. strip length	9 mm	Locking device	possible	 <p>Male – Free end</p> <table border="1"> <tr><td>Connection cable</td><td></td></tr> <tr><td>Wire ends</td><td>ultrason. welded</td></tr> <tr><td>Sheath strip length</td><td>35 mm</td></tr> <tr><td>Insul. strip length</td><td>9 mm</td></tr> <tr><td>Locking device</td><td>yes</td></tr> </table>	Connection cable		Wire ends	ultrason. welded	Sheath strip length	35 mm	Insul. strip length	9 mm	Locking device	yes				
Extension cable																															
Locking device	yes																														
Connection cable																															
Wire ends	ultrason. welded																														
Sheath strip length	35 mm																														
Insul. strip length	9 mm																														
Locking device	possible																														
Connection cable																															
Wire ends	ultrason. welded																														
Sheath strip length	35 mm																														
Insul. strip length	9 mm																														
Locking device	yes																														
<p>Application Length²⁾ m</p> <p>Extra-low voltage e.g. LED parallel, ASI-i</p> 	<table border="1"> <thead> <tr><th>Part No.</th></tr> </thead> <tbody> <tr><td>96.222.1092.8</td></tr> <tr><td>96.222.2092.8</td></tr> <tr><td>96.222.3092.8</td></tr> <tr><td>96.222.4092.8</td></tr> <tr><td>96.222.5092.8</td></tr> <tr><td>96.222.6092.8</td></tr> <tr><td>96.222.7092.8</td></tr> <tr><td>96.222.8092.8</td></tr> </tbody> </table>	Part No.	96.222.1092.8	96.222.2092.8	96.222.3092.8	96.222.4092.8	96.222.5092.8	96.222.6092.8	96.222.7092.8	96.222.8092.8	<table border="1"> <thead> <tr><th>Part No.</th></tr> </thead> <tbody> <tr><td>96.222.1097.8</td></tr> <tr><td>96.222.2097.8</td></tr> <tr><td>96.222.3097.8</td></tr> <tr><td>96.222.4097.8</td></tr> <tr><td>96.222.5097.8</td></tr> <tr><td>96.222.6097.8</td></tr> <tr><td>96.222.7097.8</td></tr> <tr><td>96.222.8097.8</td></tr> </tbody> </table>	Part No.	96.222.1097.8	96.222.2097.8	96.222.3097.8	96.222.4097.8	96.222.5097.8	96.222.6097.8	96.222.7097.8	96.222.8097.8	<table border="1"> <thead> <tr><th>Part No.</th></tr> </thead> <tbody> <tr><td>96.222.1098.8</td></tr> <tr><td>96.222.2098.8</td></tr> <tr><td>96.222.3098.8</td></tr> <tr><td>96.222.4098.8</td></tr> <tr><td>96.222.5098.8</td></tr> <tr><td>96.222.6098.8</td></tr> <tr><td>96.222.7098.8</td></tr> <tr><td>96.222.8098.8</td></tr> </tbody> </table>	Part No.	96.222.1098.8	96.222.2098.8	96.222.3098.8	96.222.4098.8	96.222.5098.8	96.222.6098.8	96.222.7098.8	96.222.8098.8	
Part No.																															
96.222.1092.8																															
96.222.2092.8																															
96.222.3092.8																															
96.222.4092.8																															
96.222.5092.8																															
96.222.6092.8																															
96.222.7092.8																															
96.222.8092.8																															
Part No.																															
96.222.1097.8																															
96.222.2097.8																															
96.222.3097.8																															
96.222.4097.8																															
96.222.5097.8																															
96.222.6097.8																															
96.222.7097.8																															
96.222.8097.8																															
Part No.																															
96.222.1098.8																															
96.222.2098.8																															
96.222.3098.8																															
96.222.4098.8																															
96.222.5098.8																															
96.222.6098.8																															
96.222.7098.8																															
96.222.8098.8																															
<p>Extra-low voltage e.g. LED serial, 24 V</p> 	<table border="1"> <tbody> <tr><td>96.222.1092.4</td></tr> <tr><td>96.222.2092.4</td></tr> <tr><td>96.222.3092.4</td></tr> <tr><td>96.222.4092.4</td></tr> <tr><td>96.222.5092.4</td></tr> <tr><td>96.222.6092.4</td></tr> <tr><td>96.222.7092.4</td></tr> <tr><td>96.222.8092.4</td></tr> </tbody> </table>	96.222.1092.4	96.222.2092.4	96.222.3092.4	96.222.4092.4	96.222.5092.4	96.222.6092.4	96.222.7092.4	96.222.8092.4	<table border="1"> <tbody> <tr><td>96.222.1097.4</td></tr> <tr><td>96.222.2097.4</td></tr> <tr><td>96.222.3097.4</td></tr> <tr><td>96.222.4097.4</td></tr> <tr><td>96.222.5097.4</td></tr> <tr><td>96.222.6097.4</td></tr> <tr><td>96.222.7097.4</td></tr> <tr><td>96.222.8097.4</td></tr> </tbody> </table>	96.222.1097.4	96.222.2097.4	96.222.3097.4	96.222.4097.4	96.222.5097.4	96.222.6097.4	96.222.7097.4	96.222.8097.4	<table border="1"> <tbody> <tr><td>96.222.1098.4</td></tr> <tr><td>96.222.2098.4</td></tr> <tr><td>96.222.3098.4</td></tr> <tr><td>96.222.4098.4</td></tr> <tr><td>96.222.5098.4</td></tr> <tr><td>96.222.6098.4</td></tr> <tr><td>96.222.7098.4</td></tr> <tr><td>96.222.8098.4</td></tr> </tbody> </table>	96.222.1098.4	96.222.2098.4	96.222.3098.4	96.222.4098.4	96.222.5098.4	96.222.6098.4	96.222.7098.4	96.222.8098.4				
96.222.1092.4																															
96.222.2092.4																															
96.222.3092.4																															
96.222.4092.4																															
96.222.5092.4																															
96.222.6092.4																															
96.222.7092.4																															
96.222.8092.4																															
96.222.1097.4																															
96.222.2097.4																															
96.222.3097.4																															
96.222.4097.4																															
96.222.5097.4																															
96.222.6097.4																															
96.222.7097.4																															
96.222.8097.4																															
96.222.1098.4																															
96.222.2098.4																															
96.222.3098.4																															
96.222.4098.4																															
96.222.5098.4																															
96.222.6098.4																															
96.222.7098.4																															
96.222.8098.4																															

¹⁾ Other cables available on request
²⁾ Other lengths available on request

Cable assemblies 2.5 mm², 20 A, AS-i, 24V auxiliary voltage, LED

**Ölflex
Classic 100
2x2.5**

**containing
halogen**







e.g. LED
parallel, AS-i:
+ = BU
- = BN

e.g. LED
serial, 24 V:
1 = BU
2 = BN

Observe the
installation
instructions in
the Technical
Data that follow
the product
pages.



Cable¹⁾ color gray

Application	Length ²⁾ m	Part No.	Part No.	Part No.
Extra-low voltage e.g. LED parallel, AS-i  	1.0	96.223.1092.8	96.223.1097.8	96.223.1098.8
	2.0	96.223.2092.8	96.223.2097.8	96.223.2098.8
	3.0	96.223.3092.8	96.223.3097.8	96.223.3098.8
	4.0	96.223.4092.8	96.223.4097.8	96.223.4098.8
	5.0	96.223.5092.8	96.223.5097.8	96.223.5098.8
	6.0	96.223.6092.8	96.223.6097.8	96.223.6098.8
	7.0	96.223.7092.8	96.223.7097.8	96.223.7098.8
	8.0	96.223.8092.8	96.223.8097.8	96.223.8098.8
Extra-low voltage e.g. LED serial, 24 V  	1.0	96.223.1092.4	96.223.1097.4	96.223.1098.4
	2.0	96.223.2092.4	96.223.2097.4	96.223.2098.4
	3.0	96.223.3092.4	96.223.3097.4	96.223.3098.4
	4.0	96.223.4092.4	96.223.4097.4	96.223.4098.4
	5.0	96.223.5092.4	96.223.5097.4	96.223.5098.4
	6.0	96.223.6092.4	96.223.6097.4	96.223.6098.4
	7.0	96.223.7092.4	96.223.7097.4	96.223.7098.4
	8.0	96.223.8092.4	96.223.8097.4	96.223.8098.4

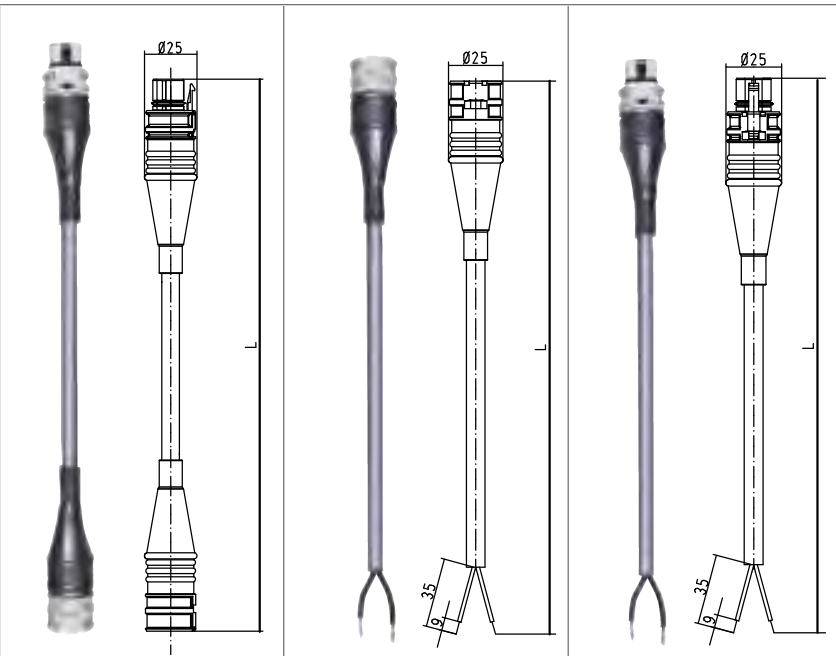

Female – Male	
Extension cable	
Locking device	yes

Female – Free end	
Connection cable	
Wire ends	ultrason. welded
Sheath strip length	35 mm
Insul. strip length	9 mm
Locking device	possible

Male – Free end	
Connection cable	
Wire ends	ultrason. welded
Sheath strip length	35 mm
Insul. strip length	9 mm
Locking device	yes

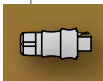

¹⁾ Other cables available on request
²⁾ Other lengths available on request

Distribution block

Distribution block 1I/3O (parallel connection), for protection class II, AS-i or LEDs

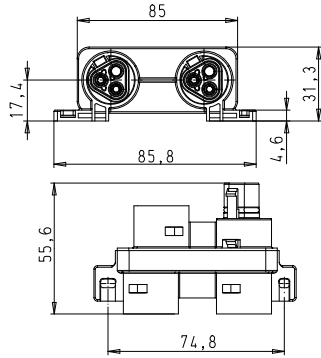

Application Coding Color

Circuit diagram

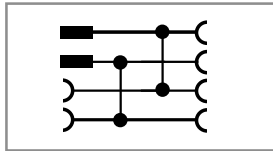

250V	Protection class II	L, N	black gray brown
Extra-low voltage	e.g. 24V	1, 2	
	e.g. LED parallel, AS-i	+, -	pebble gray

Part No.

with mounting option	
Locking device	yes
Input	1
Outputs	3
96.020.0153.1	
96.020.0153.0	
96.020.0151.4	
96.020.0150.8	

Part No.

without mounting option	
Locking device	yes
Input	1
Outputs	3
96.020.0253.1	
96.020.0253.0	
96.020.0251.4	
96.020.0250.8	

Distribution block 1 I/3 O (series connection) for power LEDs

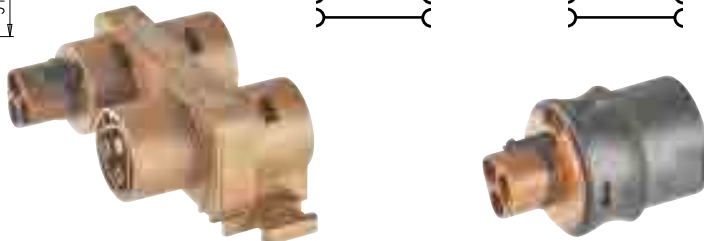
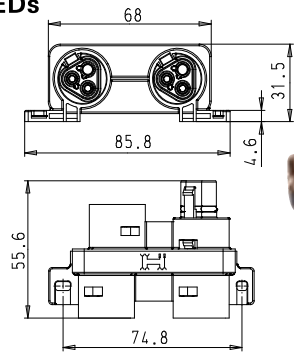

e.g. circuit diagrams

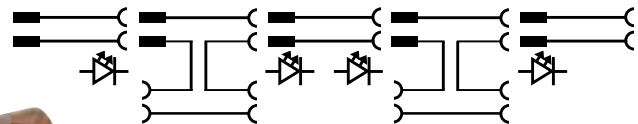

Application Coding Color

Circuit diagram

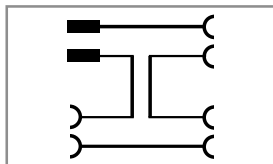

Extra-low voltage	e.g. LED serial	1, 2	brown
-------------------	-----------------	------	-------

Part No.

with mounting option	
99.910.0000.7	

Part No.

Jumper plug	
For jumpering of unused slots on the series distribution unit	
99.537.0000.7	

Distribution unit

RST compact distribution unit 1I/3O



Name	Color	Part No.
RST compact distribution unit	black	on request

Detailed information about the distribution units available in section "Distribution units".

Dimensions	104 x 162 x 57.2 mm
Fitted as required with	M25 device connectors 2 pole
Input	1, RST20i2
Outputs	3, RST20i2
Prewired with	2.5 mm ² (halogen-free)
Fastening options	yes

Circuit diagram

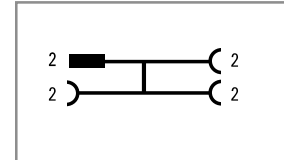

RST multi-distribution unit 1I/7O



Name	Color	Part No.
RST multi-distribution unit	black	99.946.0000.7

Detailed information about the distribution units available in section "Distribution units".

Dimensions	104 x 162 x 96 mm
Fitted as required with	M25 device connectors 2 pole
Input	1, RST20i2
Outputs	7, RST20i2
Prewired with	2.5 mm ² (halogen-free)
Fuses	6.3 or 10 A can be integrated

Circuit diagram

